

JAWBONE RESERVE – WILLIAMSTOWN

A recent U3A ramble at Williamstown (west side of the Bay about 15km from the CBD) We walked from North Williamstown train station to Jawbone Reserve, a huge freshwater lake area adjacent to the beach. The area was once part of the Williamstown Rifle Range, a restricted area which was sold off to Developers who had a massive task in cleaning up the area and setting up the reserve, prior to houses being built. The area has become one of Melbourne's largest and most popular water bird sanctuaries.

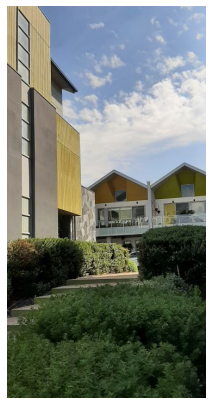

Freshwater lakes



New Housing development beside the lakes

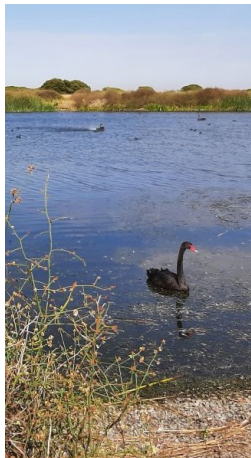

Black swan



bird life on the lakes



The beach black basalt rocks



More water birds on the extensive lakes